

te della via Em

STRALCIO 5

DEFINITIVO



AREA FOMA - PLANIMETRIA
DELLO STATO ATTUALE

B.3a
Scala: Varie

Il Responsabile del Procedimento
Ing. Davide Sornani



Data

SEZIONI STATO ATTUALE

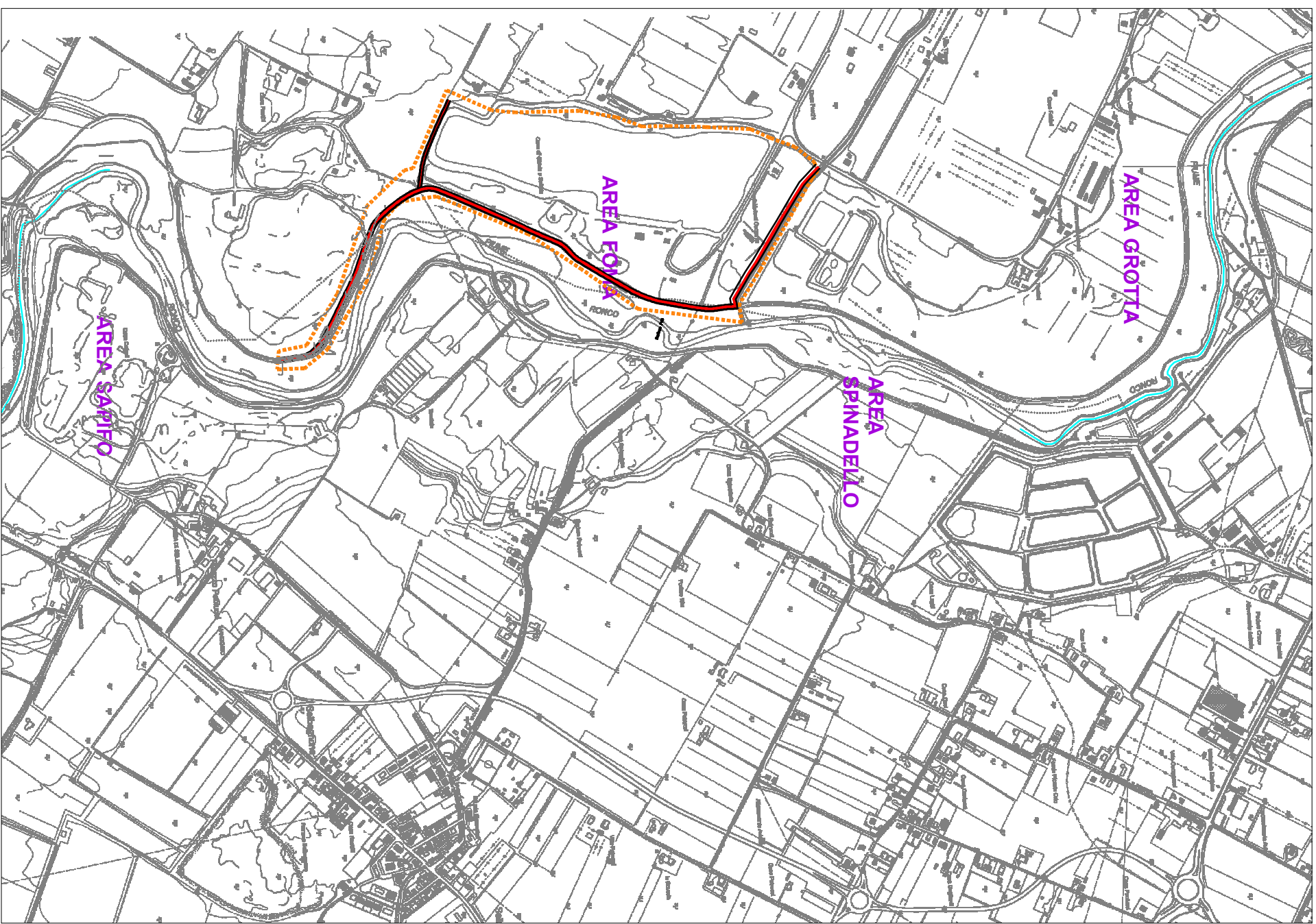
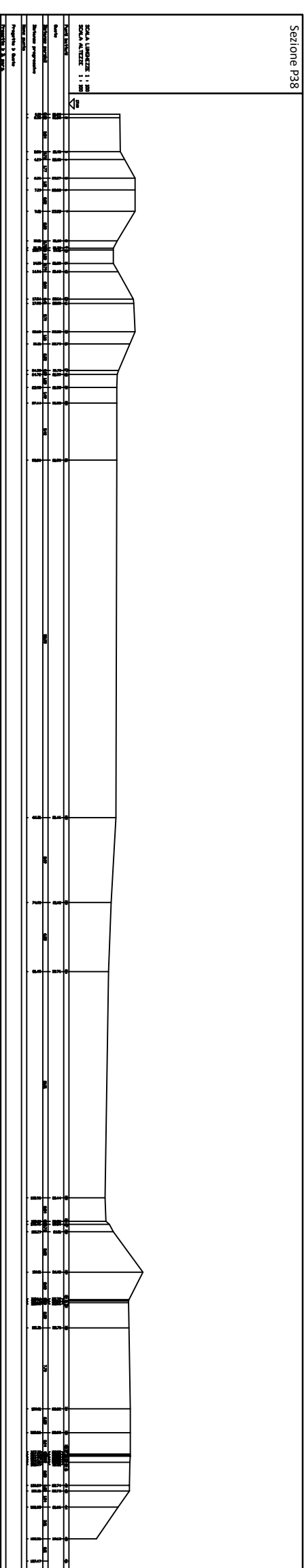
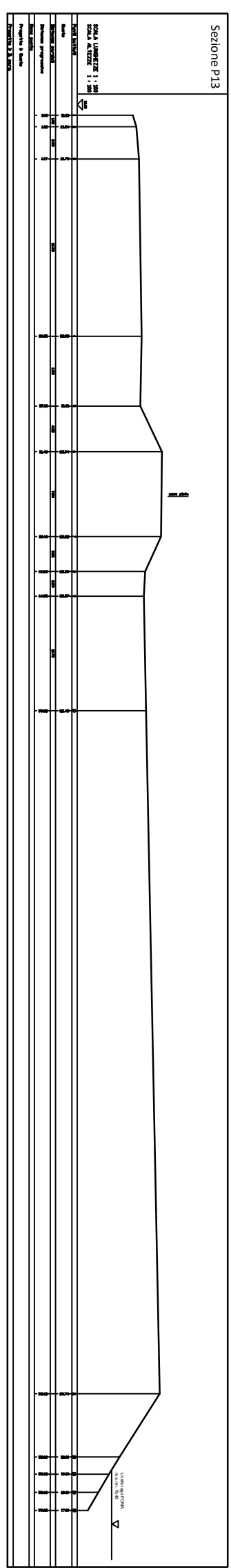
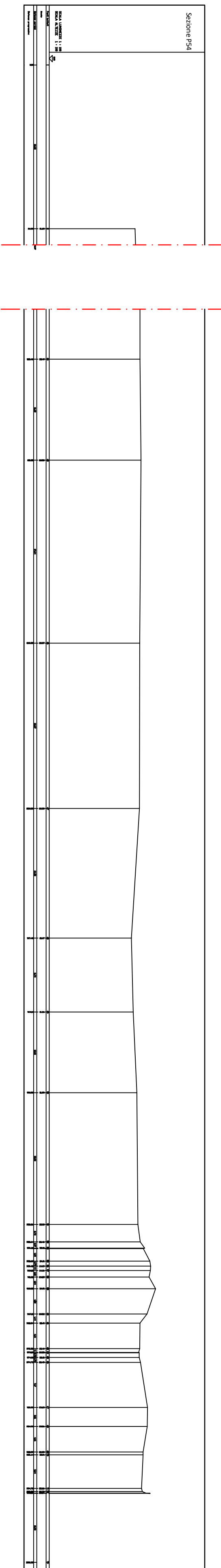
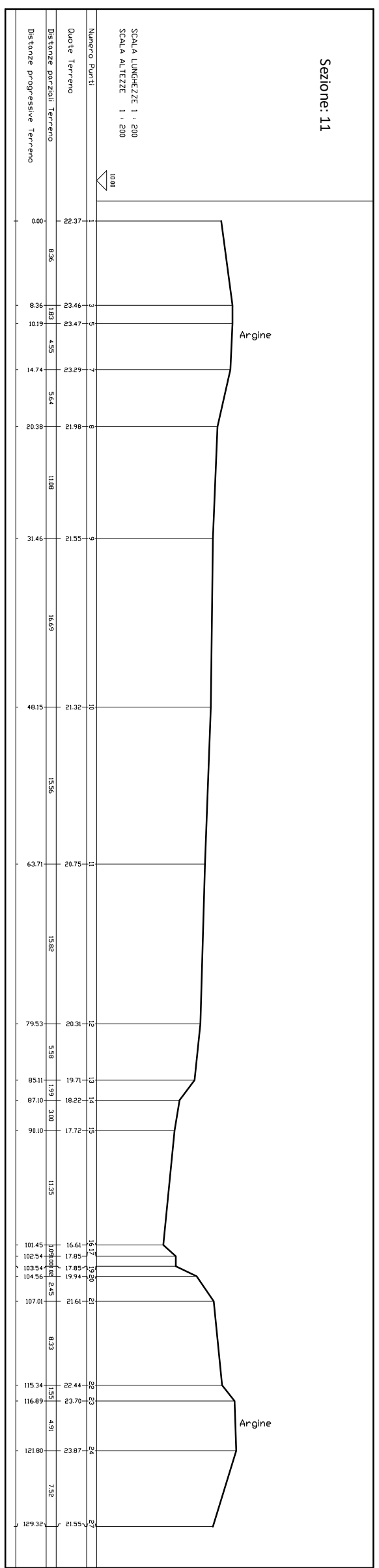
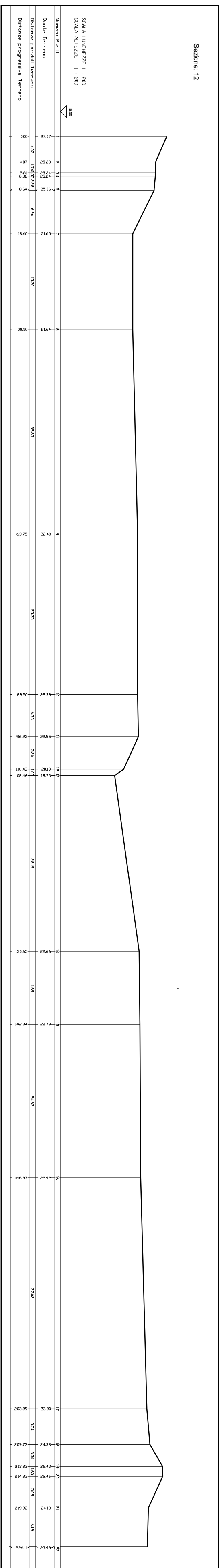
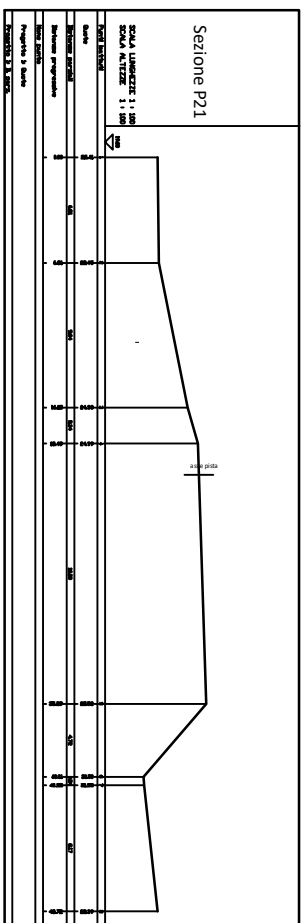
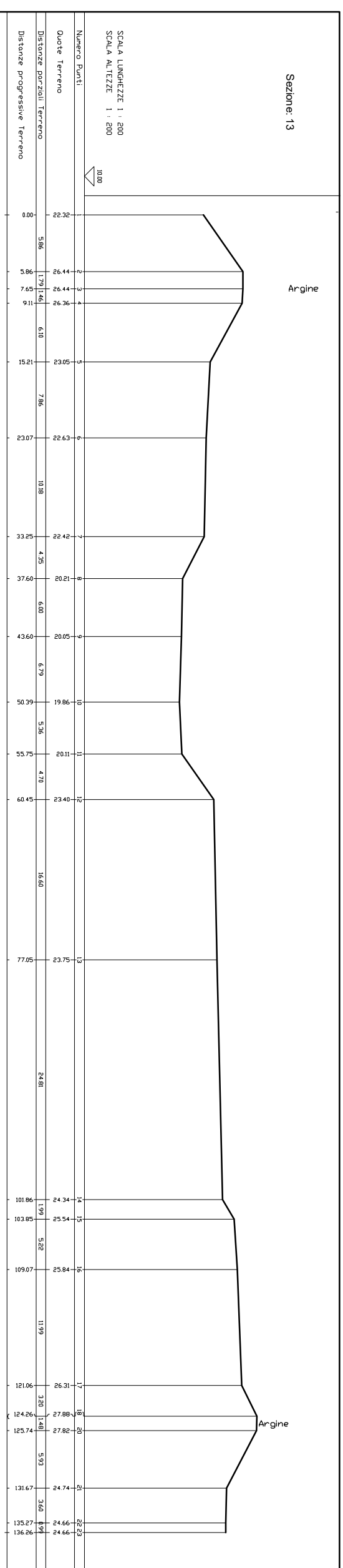
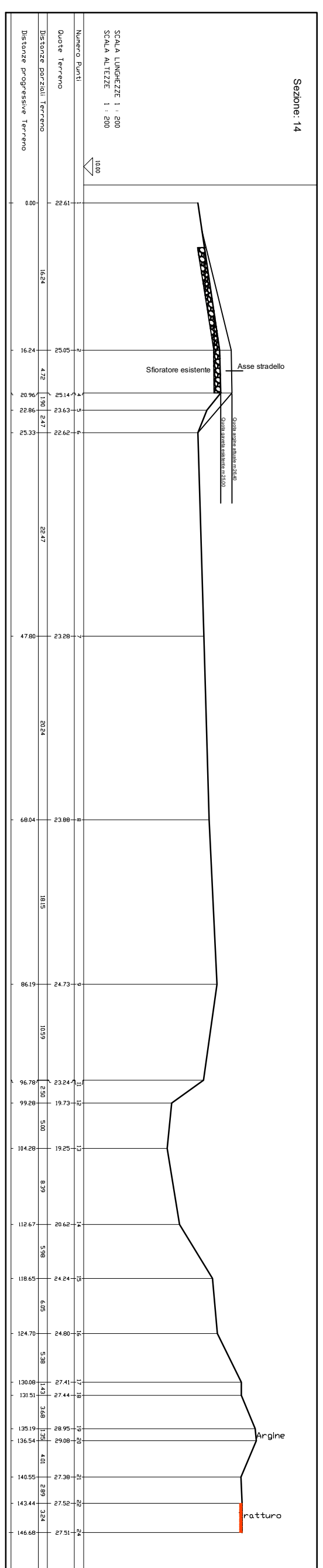

AREA COMPLESSIVA DI INTERVENTO: IN EVIDENZA AREA FOMPA

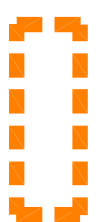

PERIMETRO DI INTERVENTO

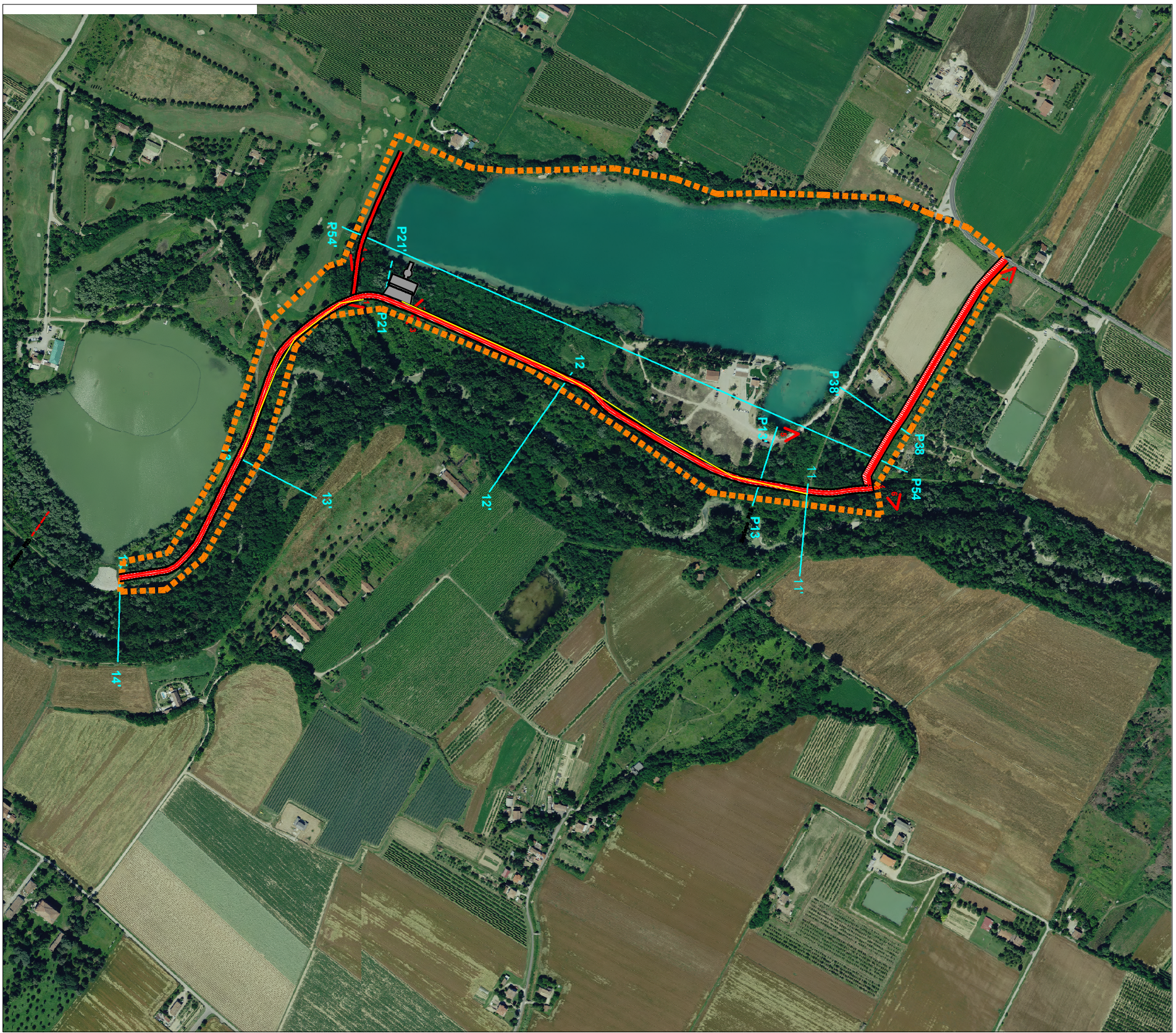

DETTAGLIO DELL'AREA FOMA SU BASE AEROFOTOGRAFOMETRICA CON TRACCE DI SEZIONE



TRACCIA DI SEZIONE



PUNTO DI PRESA FOTOGRAFICA

PRESE FOTOGRAFICHE DELLO STATO ATTUALE

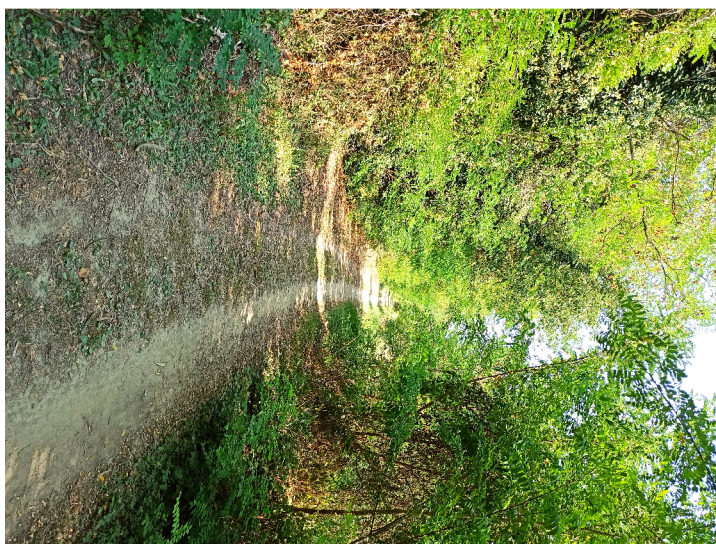

1 Stradello sopra l'argine dx Ronco nel punto dove si prevede lo sfioratore



2 Come sopra, verso il lago FONIA



3 Come sopra, verso il fiume.



4 Argine da rialzare tra il lago FOMA e il campo da golf



5 Punto in cui sarà realizzato o scarico di fondo



6 Confluenza del Rio Tibano con il fiume



7 Argini del Rio Tibano