

FONDAZIONE TIPO A
Scala 1:50

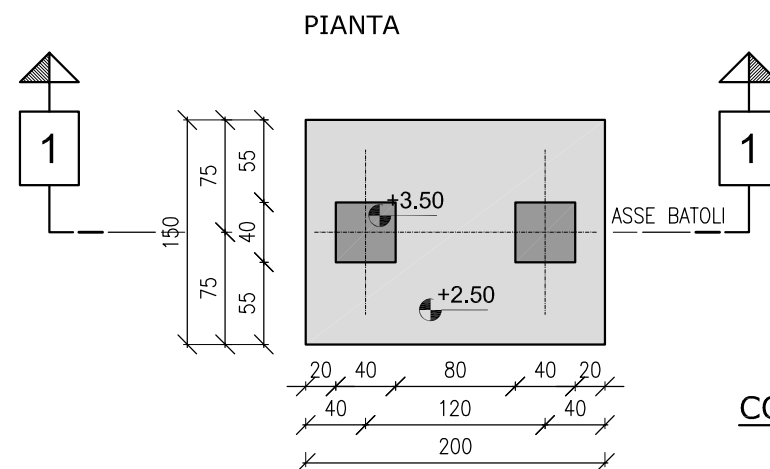

CORDOLO DI COLLEGAMENTO
Scala 1:50

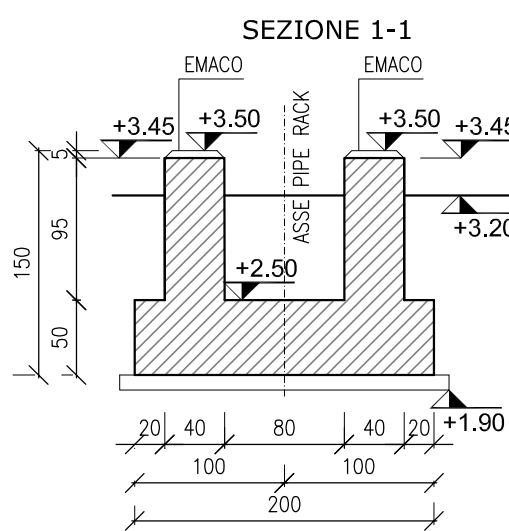
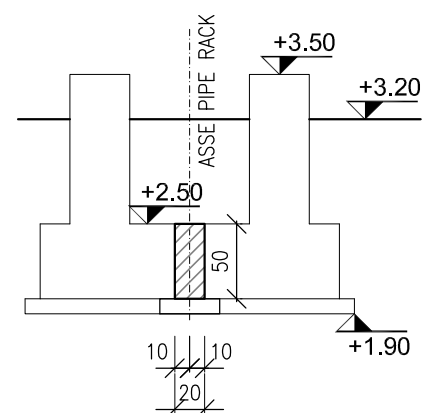

FONDAZIONE TIPO B
Scala 1:50

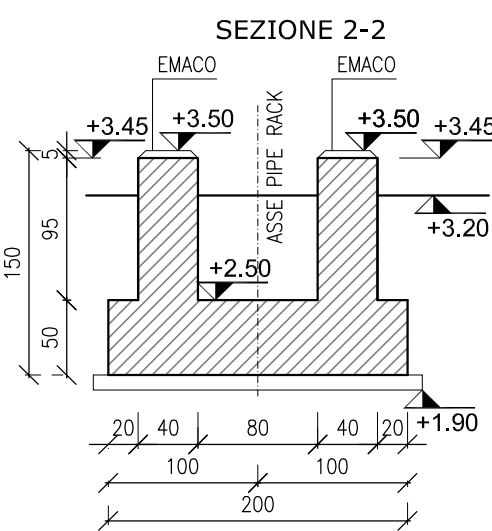
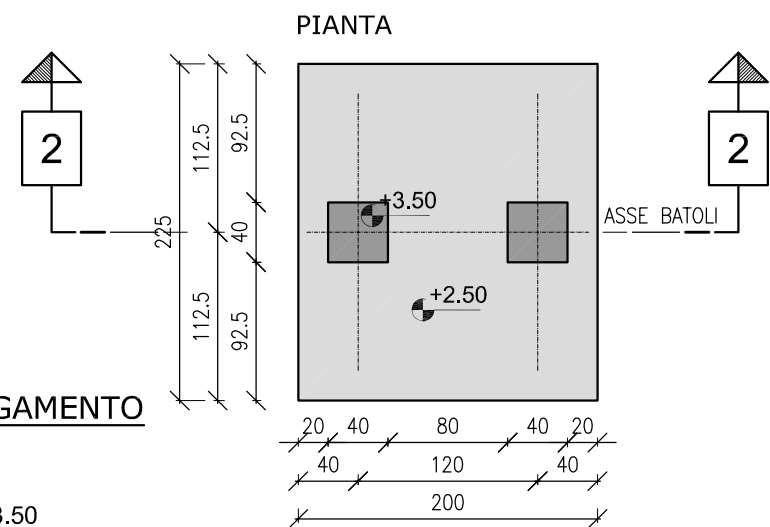

FONDAZIONE TIPO B'
Scala 1:50

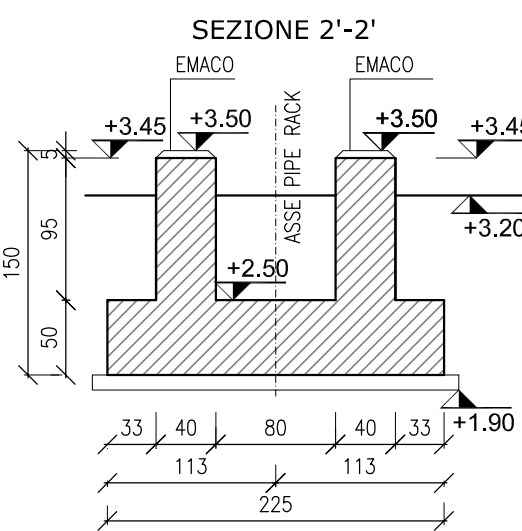
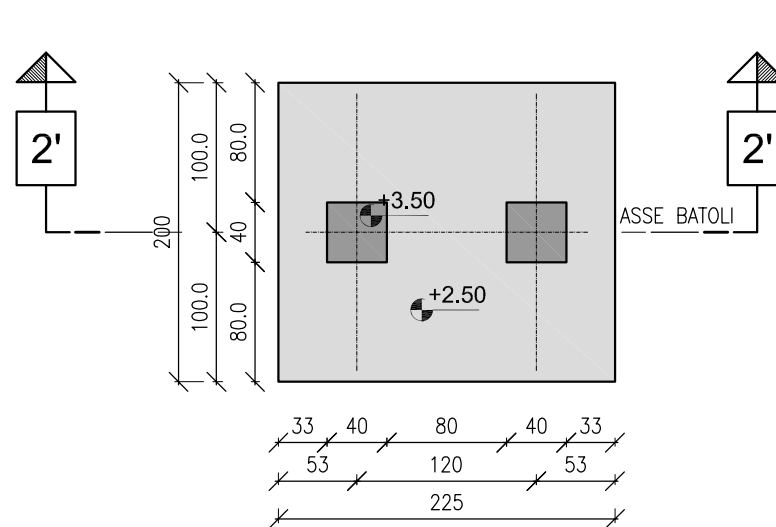

FONDAZIONE TIPO C
Scala 1:50

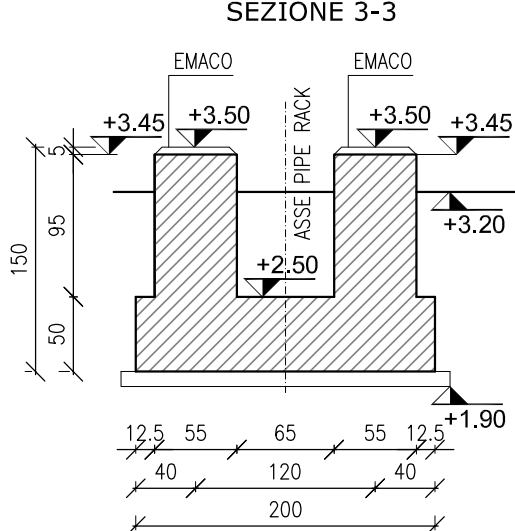
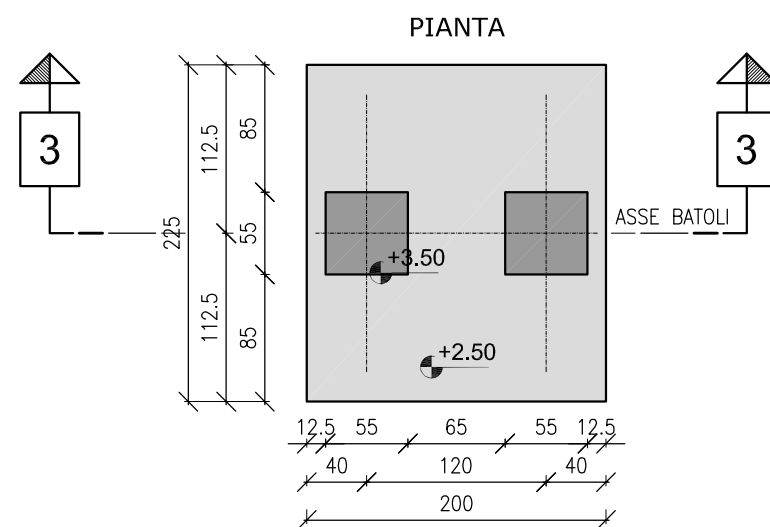

FONDAZIONE TIPO D
Scala 1:50

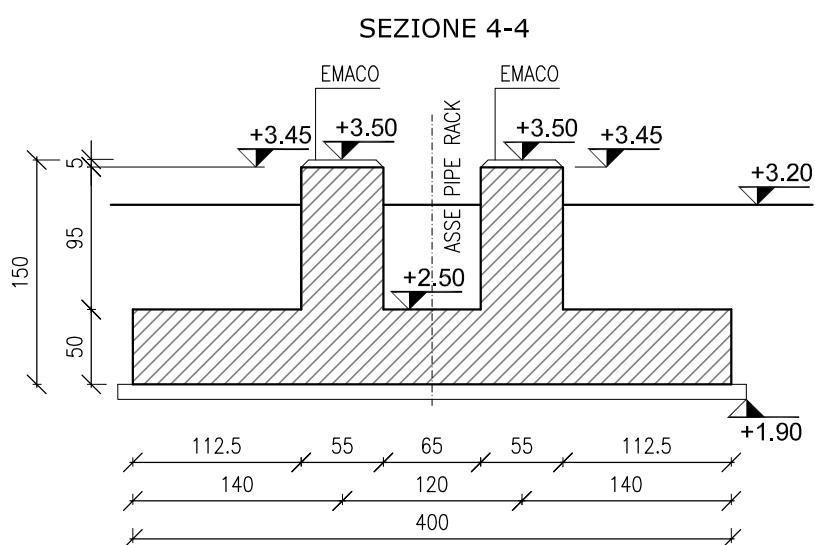
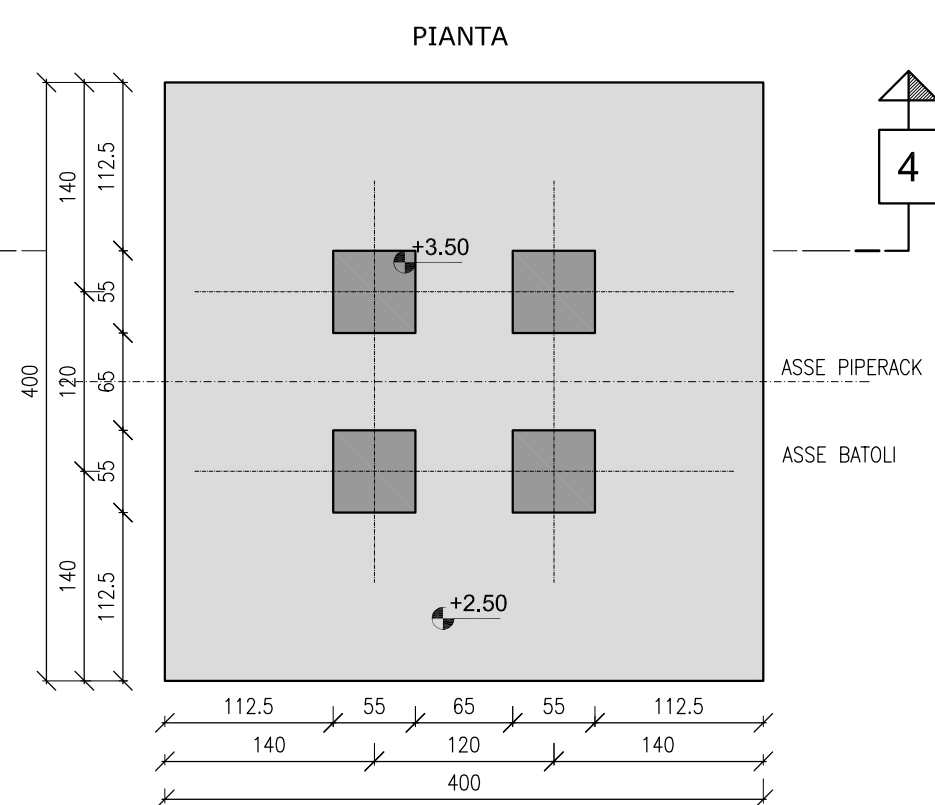

FONDAZIONE TIPO D'
Scala 1:50

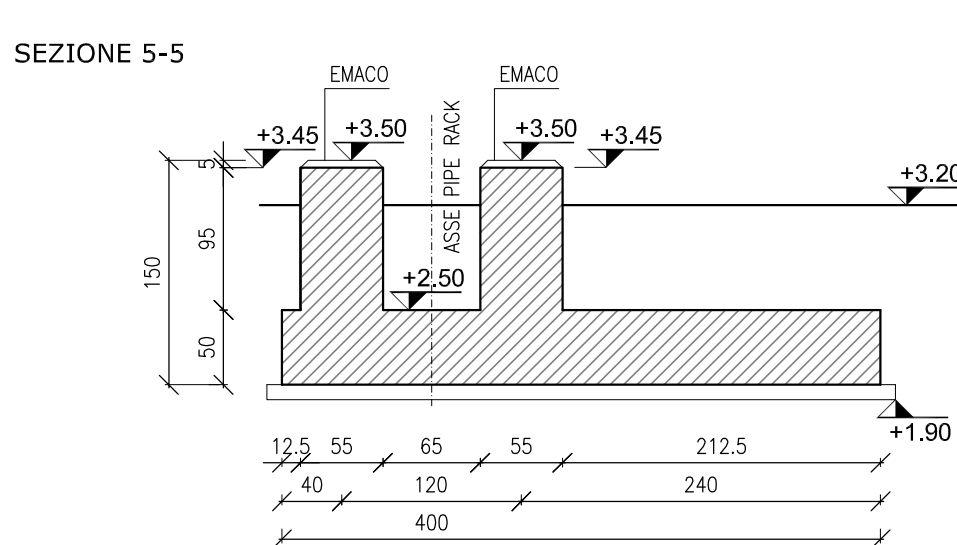
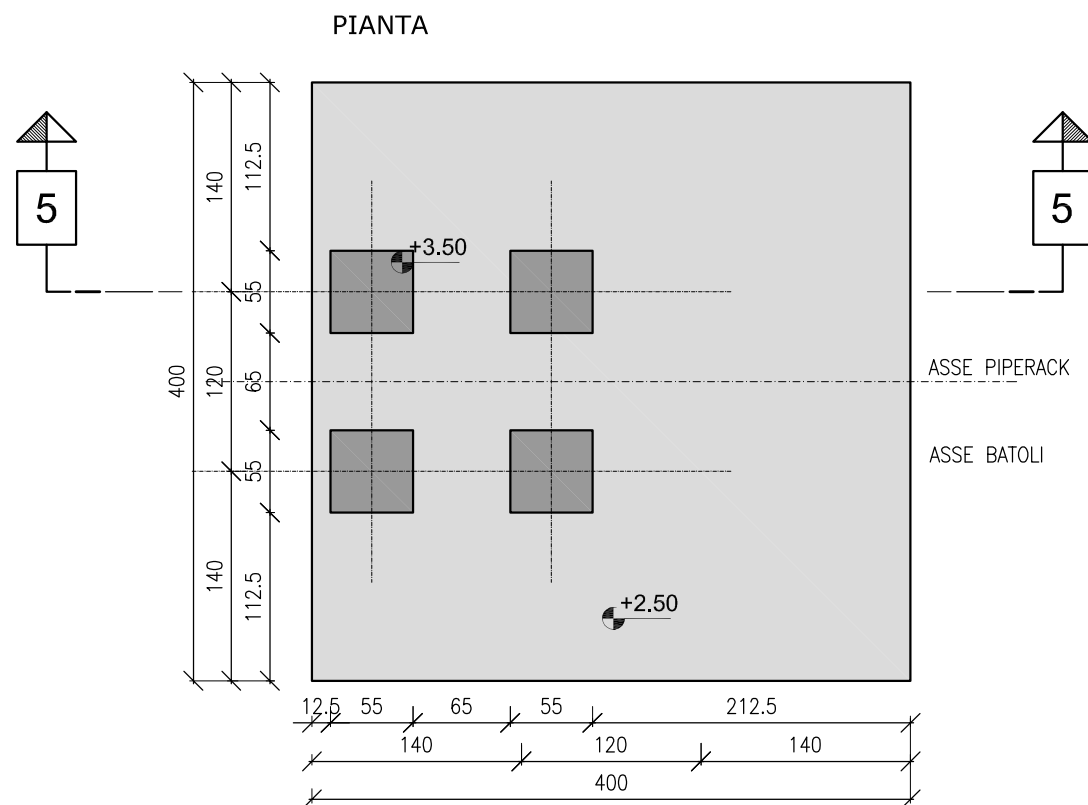

FONDAZIONE TIPO E
Scala 1:50

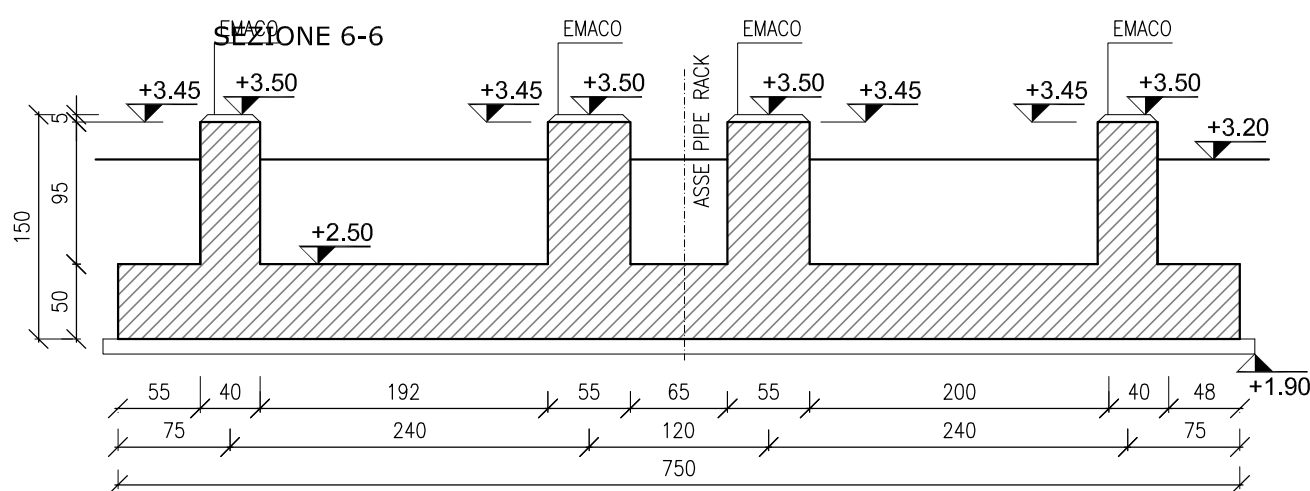
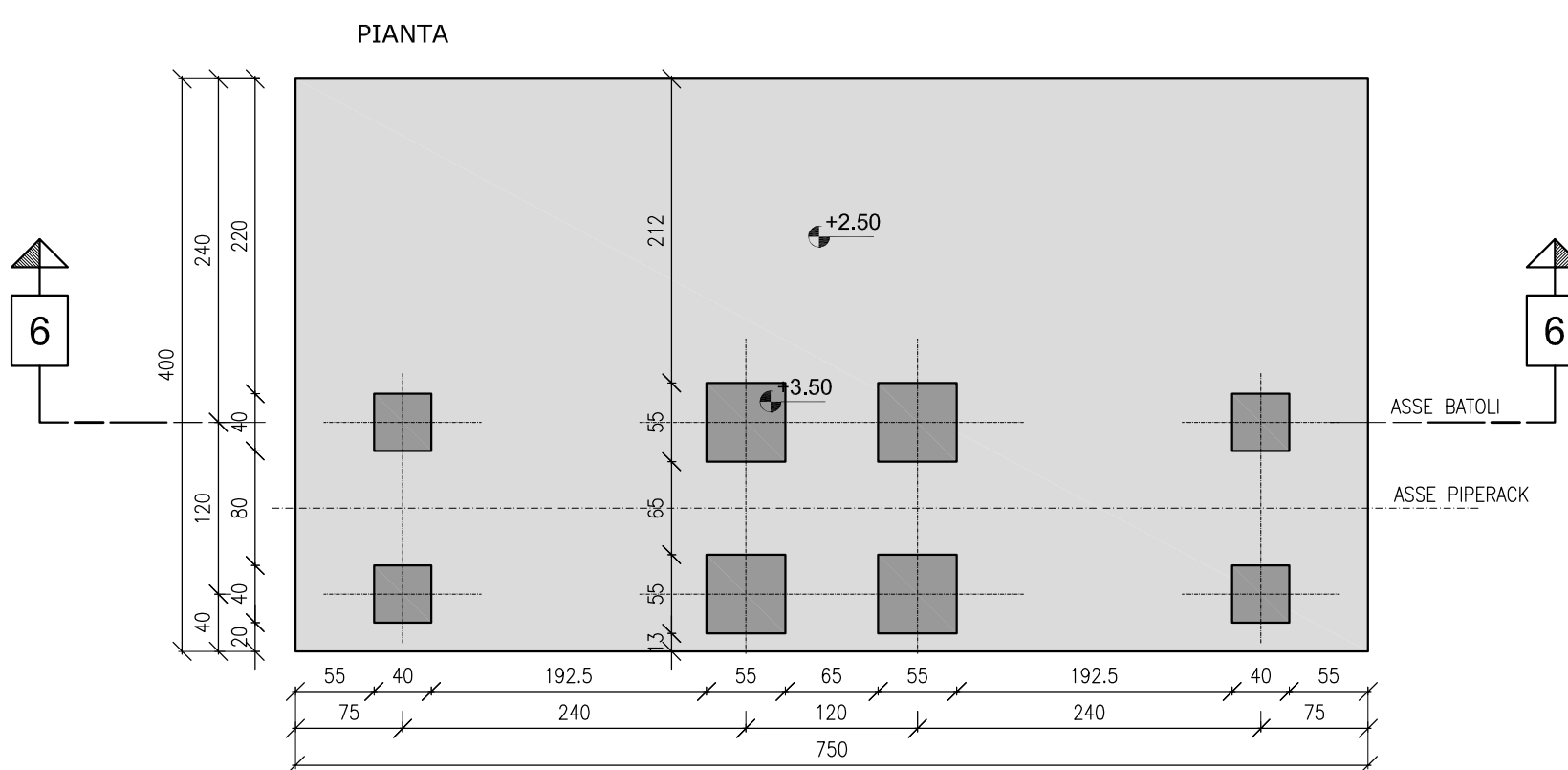

FONDAZIONE TIPO E'
Scala 1:50

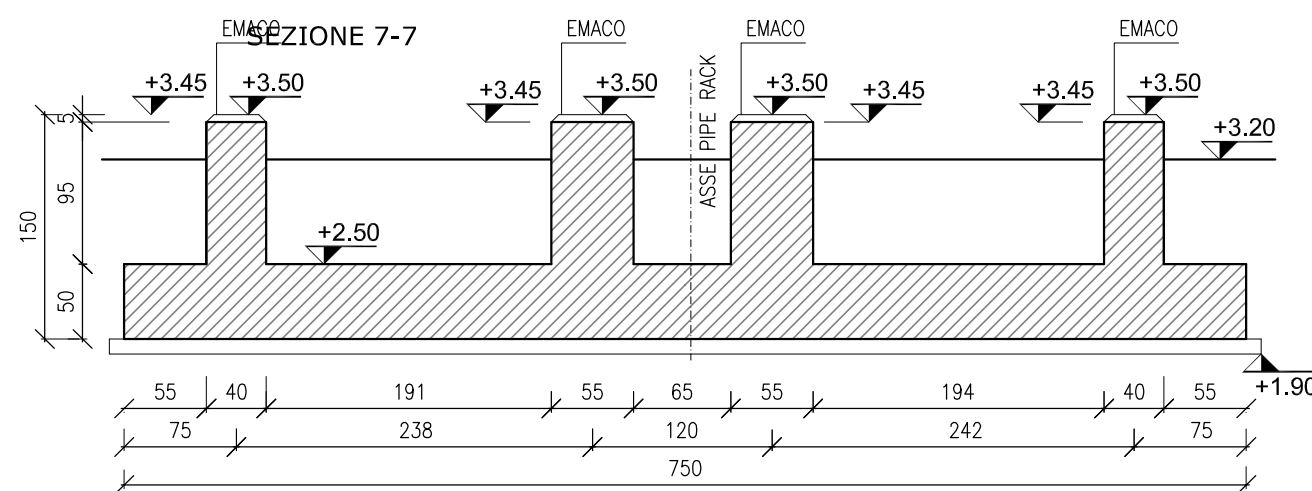
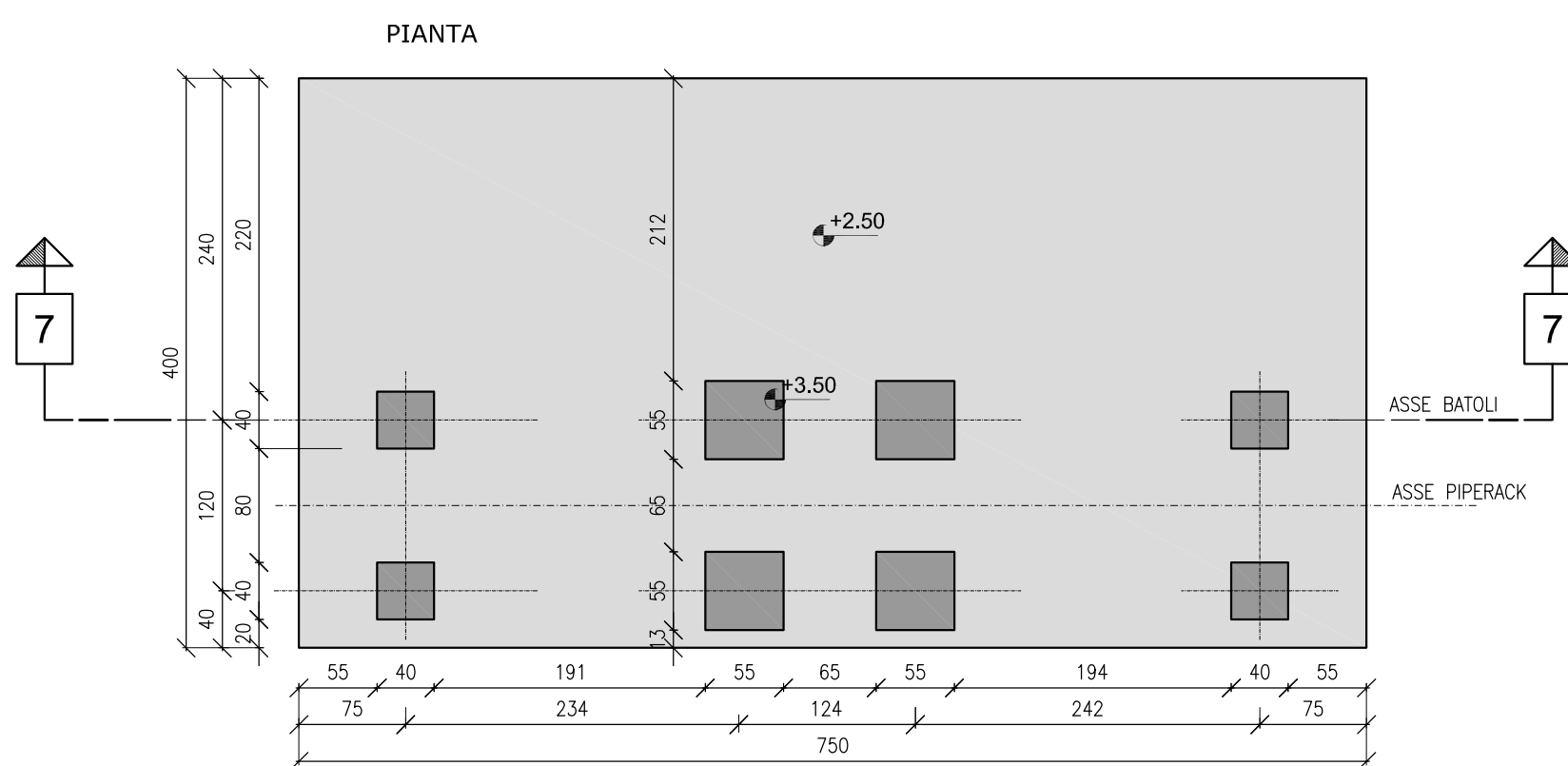

DETTAGLIO 1
Scala 1:50

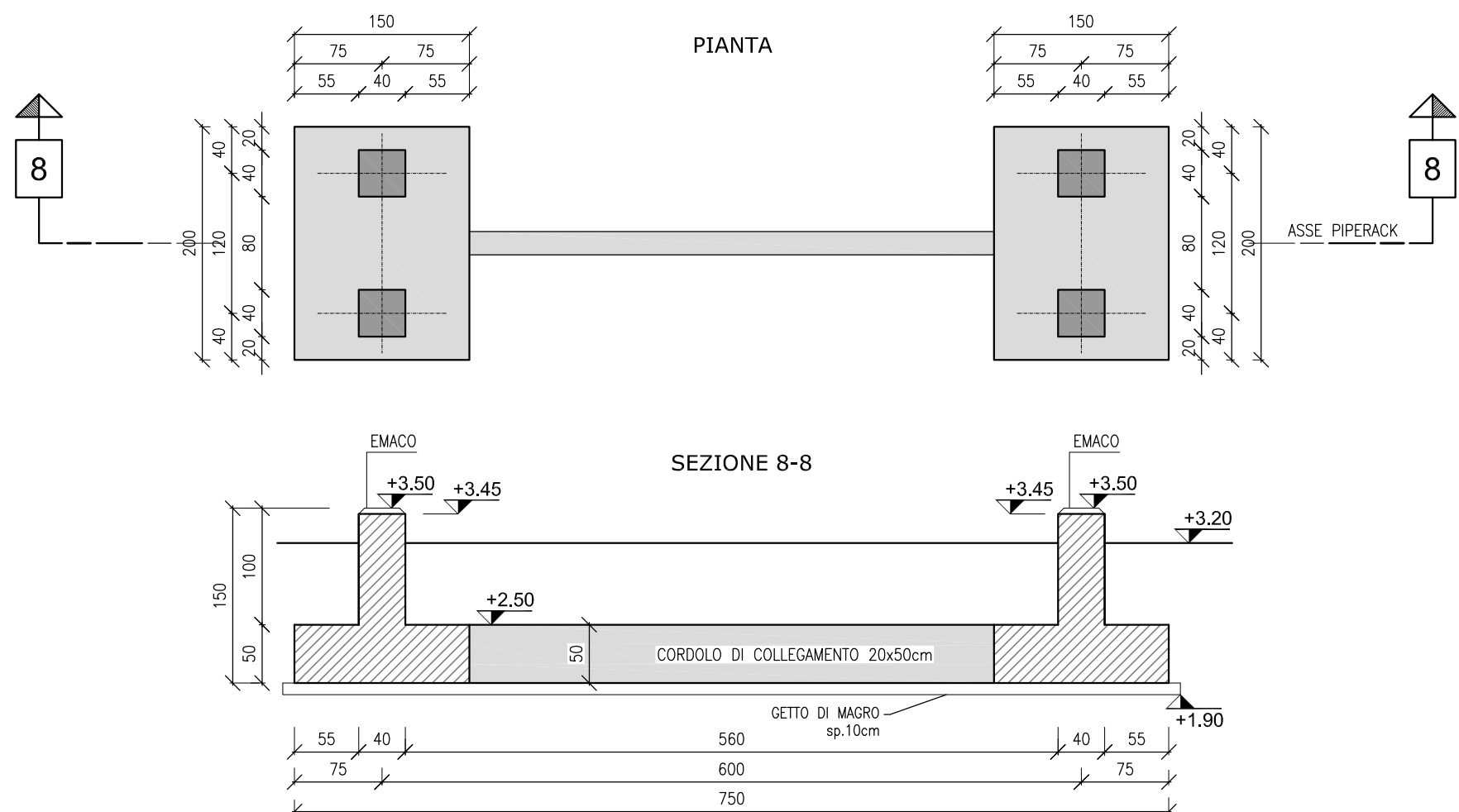

— PRESCRIZIONE MATERIALI —

Magro dosato a q.li 2.0 di CEMENTO 300

CLS C25/30

CLASSE ESPOSIZIONE XC2

ACCIAIO per C.A. B450C ad aderenza migliorata conforme al D.M. 17/01/2018

DIAMETRO MAX INERTI : 30mm

CONSISTENZA AL GETTO SOLETTE: S4

COPRIFERRO: min. 4 cm sulle staffe

SOVRAPPOSIZIONE ARMATURE : MIN.50 diametri

— NOTE —

1) Ove non diversamente specificato, le misure sono espresse in cm

2) Incidenza armatura in fondazione 100 Kg/mc

3) Per il coposaldo di quota si fa riferimento alla tavola

n°090026-ENG-D-DG-3022

LEGENDA

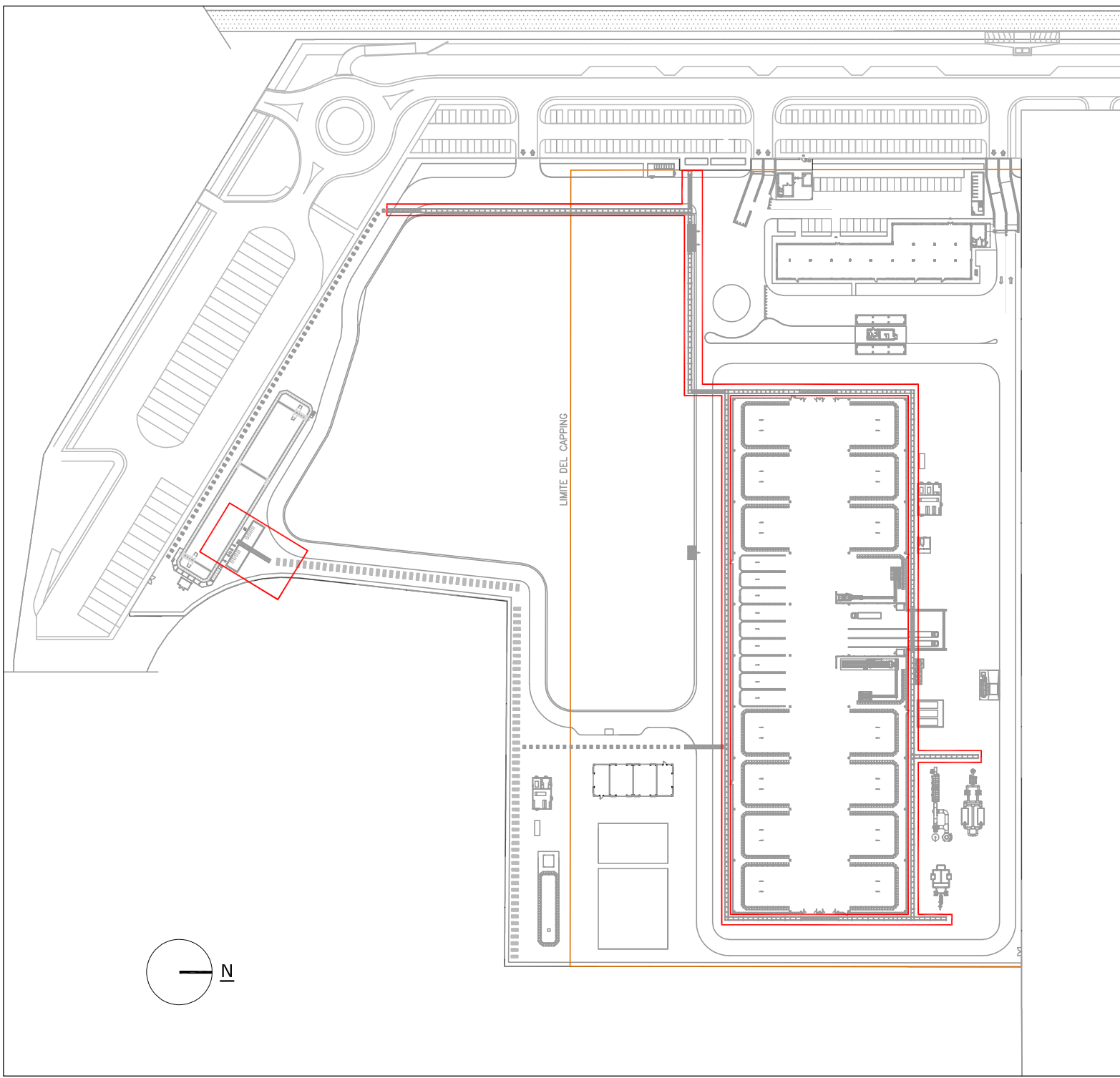
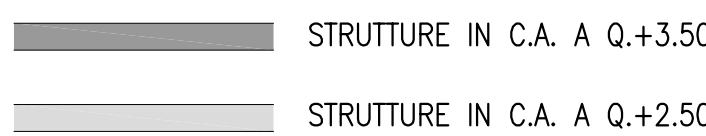

PIANTA CHIAVE
Scala 1:2000



00 EMISSIONE PER FEED		11/12/2020	GOLDER	INPRO/YESO	INPRO	
IND. DI REV.	DESCRIZIONE - Description	DATA - Date	ELAB. - Prep.d	VERIF. - Chk'd	APPR. - Appr.d	CLIENTE
						SITO Eni Rewind
						RAVENNA AREA PONTICELLE
PVI: 090026	Questo disegno è di proprietà Eni Rewind S.p.A. che se ne riserva tutti i diritti. La copia, una volta prelevata dal sito, è in stato non controllato; prima dell'utilizzo verificare la validità della revisione.	SOSTITUITO DA:				
N° COMMESSA CA-BAV-000000		SOSTITUISCE IL:				
FUNZIONE EMITTENTE INGEA/IMPRO		PIATTAFORMA BIO-RECUPERO "PONTICELLE"				
SCALA 1:50		FONDAZIONI PIPERACK PIANTA E SEZIONI				
DATA Date	11/12/20					
N° DOC. 090026-ENG-D-DG-3045	N° DOC. APPALTAIORE	20148029_CC_026	IND. DI REV. 00	FG. 2	DI 3	
UNITA' DI MISURA/Units of measure:			SCALA DI PLOTTAGGIO/Plot scale: 1:1			